

Roll No. 135091802008501

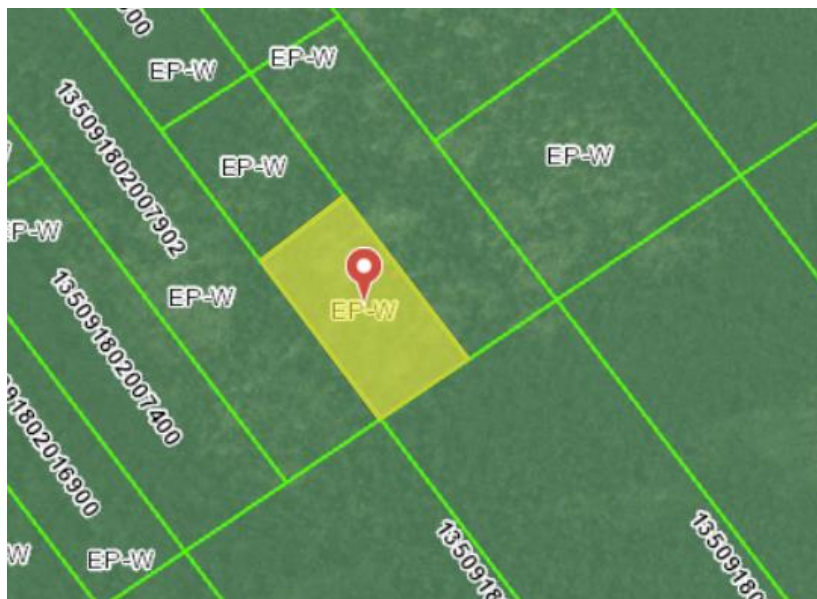

Civic Address: Land Locked (off tubbs road)

Legal Address: CON 3 WGP PT LOT 48



Ward: Sophiasburgh

Road Access: (land locked)

Zoned: EP-W Environmental

Roll No.: 135091802008501

Area: 15 Acres

Surplused: vested and declared surplus. Committee of Whole August 11, 2011 Adopted by Council August 30, 2011

SECTION 32 ENVIRONMENTAL PROTECTION – PROVINCIALY SIGNIFICANT WETLAND (EP-W) ZONE

No person shall within any Environmental Protection - Provincially Significant Wetland (EP-W) Zone use any land, or

erect, alter or use any building or structure except in accordance with the following provisions.

32.1 PERMITTED NON-RESIDENTIAL USES

32.1.1 conservation uses including activities connected with the conservation of soil and wildlife

32.1.2 forestry

32.1.3 flood, sedimentation and erosion control uses and structures as approved by Quinte Conservation.

32.1.4 sustainable resource management uses such as fishing, hunting and wildlife viewing

32.1.5 docks and boathouses in accordance with the provisions of Section 4.1.6 of this By-law

32.1.6 existing agricultural uses, excluding new buildings and structures

32.2 PERMITTED RESIDENTIAL USES

32.2.1 residential uses are prohibited

32.3 REGULATIONS FOR PERMITTED USES

32.3.1 No minimum area or frontage shall be required for any lot

32.3.2 Docks and boathouses shall only be permitted with written approval from the Conservation Authority.

32.3.3 Maximum Lot Coverage (all buildings and structures) 35%

32.3.4 Minimum Landscaped Open Space 35%

32.3.5 Maximum Height of Buildings 10 m (32.8 ft.)

32.4 GENERAL ZONE PROVISIONS AND PARKING, DRIVEWAY AND LOADING PROVISIONS

All provisions of Section 4, General Provisions and Section 5, Parking, Driveway and Loading Provisions, of this By-law where applicable to the use

County of Prince Edward Comprehensive Zoning By-law 1816-2006

October 23, 2006 433 of any land, building or structure permitted within the Environmental Protection - Provincially Significant Wetland (EP-W) Zone shall apply and be complied with.

For information on:

Prince Edward County Comprehensive Zoning By-law

Prince Edward County Interactive Zoning Map

Prince Edward County Official Plan

Prince Edward County Secondary Plan

Visit:

www.pecounty.on.ca/government/planning_services/planning.php



TheCounty
PRINCE EDWARD COUNTY • ONTARIO

Community Development Department, 332 Main Street, Picton, ON, K0K 2T0

E: cdd@pecounty.on.ca T: 613.476.2148